



Pre-Engineering Building Manufacturer

World  
Class

# Pre- Engineered Building Structure

---

Our state-of-art facility fabricates high-quality PEB components to create structure that match international construction and safety standards



[www.samartechmetals.com](http://www.samartechmetals.com)

# Your One Stop Solution Engineering



"SamarTech Metals" was established in the year 2018, at Nissing (Haryana, India). Our product range comprises Color Coated Metal Roofing & Cladding Sheets, Turbo Ventilators, Ridge Ventilators & many more. We have gained a phenomenal success in this domain by offering our clients unmatched quality range of products. The entire assortment is precisely designed and developed under the supervision of qualified engineers and skilled personnel using the best quality raw material.

Acknowledged for sturdy construction, high tensile strength, easy installation, low maintenance, dimensional accuracy, excellent performance and longer service life, these products are widely reckoned by clients. Further, these products can easily withstand high temperature. Owing to the incredible features, these products are widely used in chemical, automobile, construction, sugar, paper and electronics & electrical industries. To take care of the high demand for our quality components, we have created a state-of-the-art manufacturing facility in Nissing itself, under the brand name ARX Metals, which caters to a wide range of clients from across the country and even the world.

Here, we work towards creating all types of custom components that meet the strictest requirements of industrial use, such as air conditioning, soundproofing, hygiene control, fireproofing, rust resistance, heat resistance, natural lighting and much more. This makes them the preferred product of choice for different industries that require special structures for custom operations, such as pharmaceuticals and F&B, among others.



**30**<sup>+</sup> Years of Experience

**20**<sup>+</sup> Custom's Components

**99**<sup>+</sup> Complete Projects



## Why Samartech

We design as per the specific needs & requirement of the clients, We apply latest production & quality management techniques, We ensure timely delivery of consignments, we quote reasonable prices to our valued clients. We provide excellent pre sale & after sale service back up to assist our clients.



### Safety First

We double check all our components to ensure the safety of our structures.



### Uncompromising Integrity

We fulfill all our projects within time and on budget, as promised.



### Work Specialization

We specialize all our products to meet specific use cases of different clients.



### Meeting Customer's Requirement

Our wide range of components can help meet even the most extensive client needs.



### Quality, Without Question

We only feature high quality products, in both raw materials and client structures.



### Honest Design & Analysis

We always provide an authentic view of the project, irrespective of the challenges.

## Our Services

SamarTech Metals brings a host of world class products to our clients, which are supported by equally high-quality services related to those products. Here is a small look at what we offer, in terms of both new construction, as well as a system revamp.

- Pre-Engineering Design Construction
- Architectural Drawings
- Site Design & Analysis
- Architectural 3D Modeling



# Complete Structure Design



## Pre Engineering Building Details

### Primary Structural Members:

Main Frame—Columns, End-wall Posts, Rafters, Solid Web, Other Main Support Members.

### Secondary Structural Members:

Purlins & Girts, Eave Strut, Cable, Angle, Pipe, Built-up, Road Bracing, Wide Bay Truss Purlins (Cold Formed/HR).

### Roofing/Claddings:

Pre-painted Galvalume (Alu-Zinc) Sheeting is a multilayer coated profile with environment specific paint coating and is available with or without insulation. PPGL panels are offered with wide range of coatings namely SMP, SDP, PVDF; commensurate with project location.

### Interlock (Standing Seam Roof-SSR):

Leak-proof, Zero Maintenance, Interlocking

Panels, 3600 Mechanical Seam, 76mm Deep Crest, Full Seamed Roof, Movable Clip, Factory Mader SSR.

### Accessories:

Fasteners, TUF-Dom Lite, Sliding Door, Mastic Tape, Walk-way Door, Insulation, Glazing Windows, Roof Curb, Fixed Ventilation, Roof Jack, Turbo Vents, Roll up Doors, Ridge Vent Sealants.

### Erection and Installation:

From selection of appropriate structures to economic designs, we monitor and supervise the entire project till completion.

### Industry Applications:

Airports, Automobiles, Commercial Buildings, Engineering & Manufacturing, Food Processing, Infrastructure, Pharmaceuticals, Power, Retail, Textile, Warehousing & Logistics.

### Installation Tools:

Hydra, Cranes, Scissor Lift.

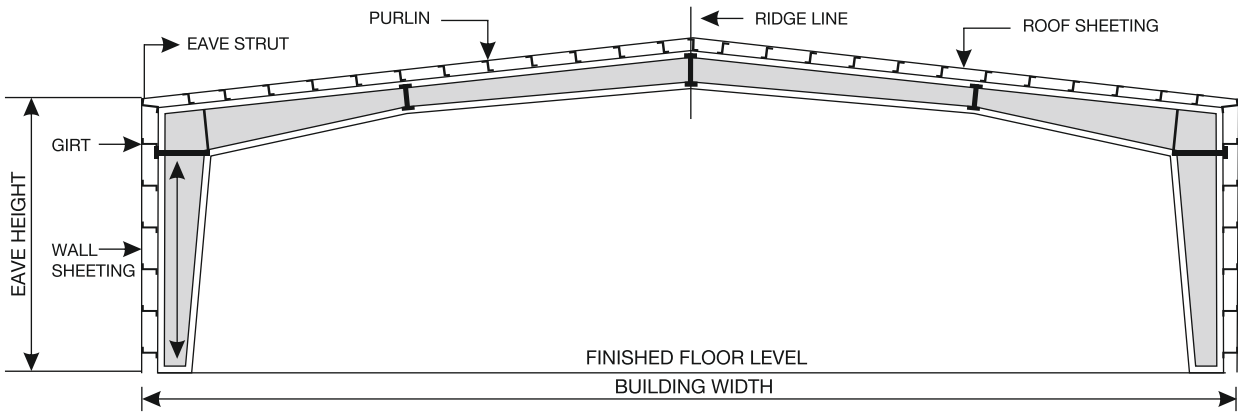

**Typical Cross Section**

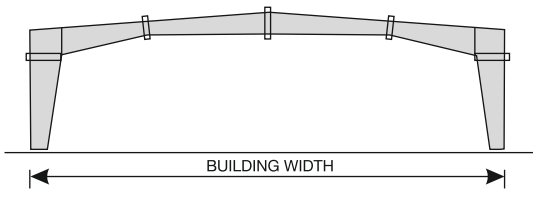

**Clear Span (CS)**

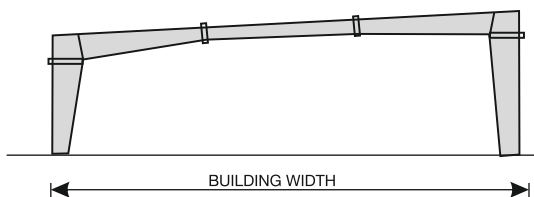

**Single Slope (SS)**

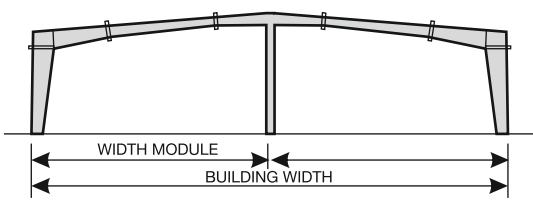

**Multi-Span "1" (MS-1)**

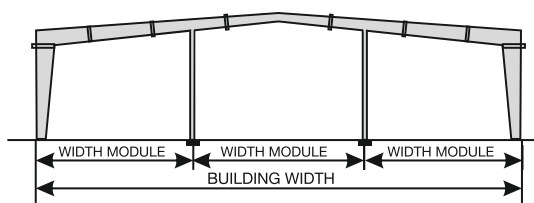

**Multi-Span "2" (MS-2)**

**OUR COMPONENTS**

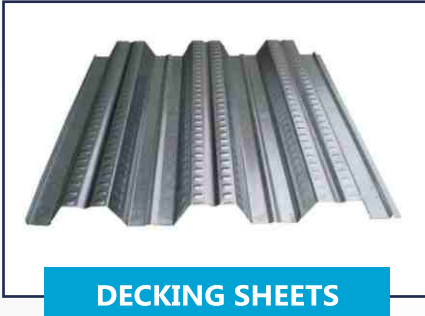

**DECKING SHEETS**



**LOUVER**



**COLOR COATED SHEET**

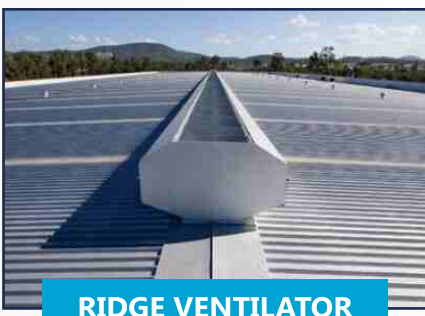

**RIDGE VENTILATOR**



**GALVULUME SHEET**



**TURBO VENTILATOR**

# Customer's Requirement



Company Name

---

---

Client Name

---

---

Area (sq. meters)

---

Quotation

---

---

---

---

---



## OUR SATISFIED CUSTOMERS

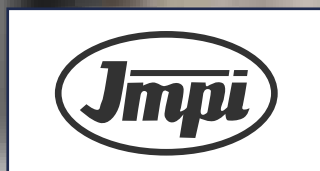
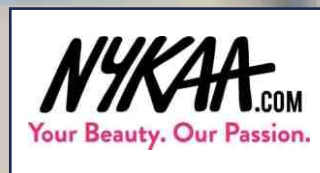

# Pre Engineering Building Work







# SAMARTECH

## METALS

Pre-Engineering Building Manufacturer

## GET IN TOUCH

 Sambli Mor, Near Sangatpura  
Gurdwara Sahib, Nissing,  
Karnal Haryana-132024 (India)

 01745-270003  
091-98960-60602

 [info@samartechmetals.com](mailto:info@samartechmetals.com)

 [www.samartechmetals.com](http://www.samartechmetals.com)

